

NOTICE OF PROPRIETARY RIGHTS
 THIS DOCUMENT CONTAINS CONFIDENTIAL TECHNICAL DATA, INCLUDING TRADE SECRETS, PROPRIETARY TO TIMES MICROWAVE SYSTEMS. DISCLOSURE OF THIS DATA IS EXPRESSLY CONDITIONED UPON YOUR ASSENT THAT ITS USE IS LIMITED TO USE WITHIN YOUR COMPANY ONLY. ANY OTHER USE IS STRICTLY PROHIBITED WITHOUT THE PRIOR WRITTEN CONSENT OF TIMES MICROWAVE SYSTEMS.

| REV. | REVISION DESCRIPTION | DFTM | DATE | APPD | DATE |
|------|-------------------------|------|----------|------|----------|
| A | RELEASED FOR PRODUCTION | M.E. | 03/24/14 | M.E. | 03/24/14 |

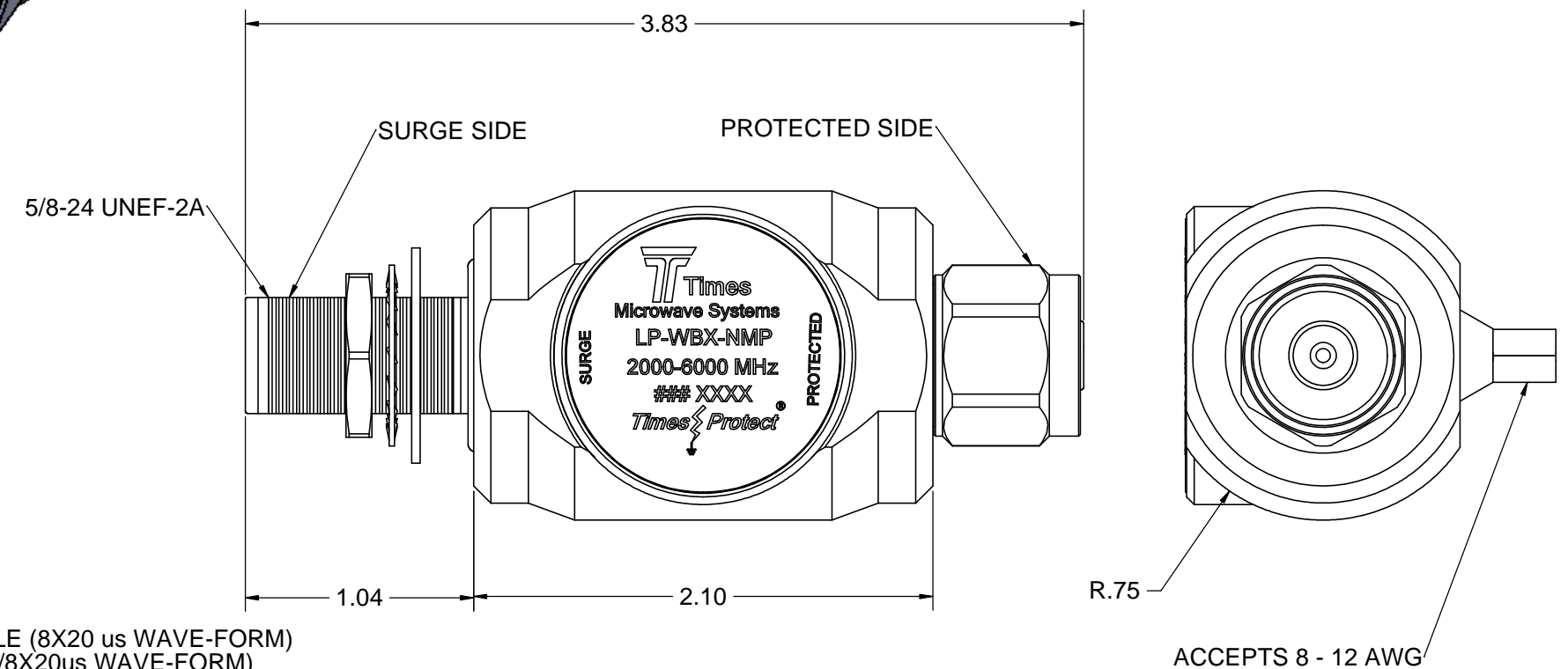
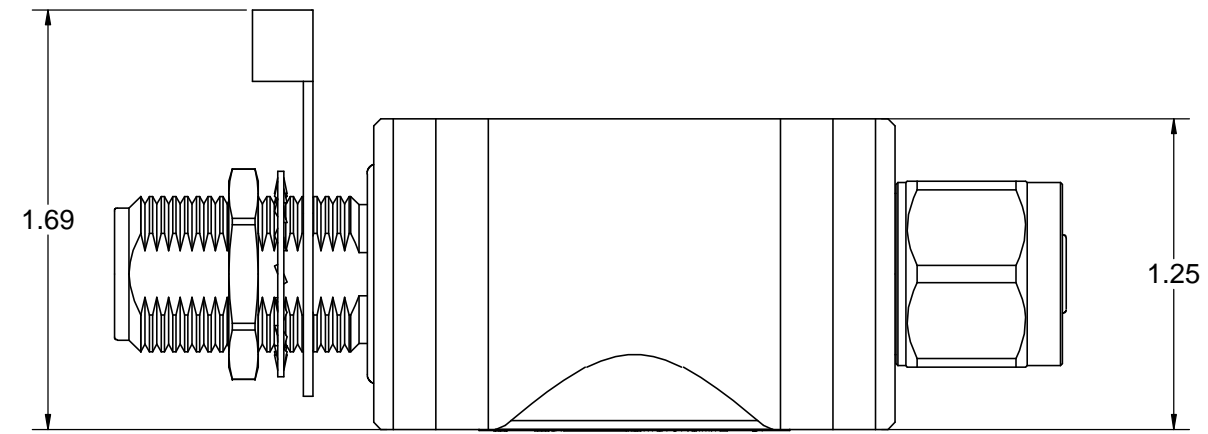
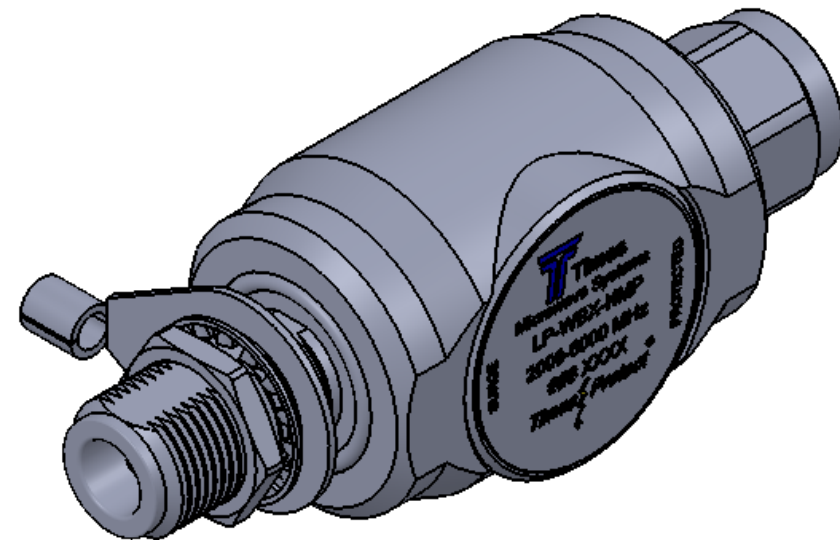

NOTES:

1. ELECTRICAL PERFORMANCE

IMPEDANCE: 50 OHMS
 OPERATING FREQUENCY: 2000-6000 MHz
 VSWR/RETURN LOSS: < 1.2:1 / < -20 dB
 INSERTION LOSS: < 0.2 dB
 AVERAGE POWER: 50 W
 MAX SURGE CURRENT: 20 kA MAX / 10 kA MULTIPLE (8X20 us WAVE-FORM)
 RESIDUAL PULSE VOLTAGE: < 3 V (6kV/3kA 1.2X50/8X20us WAVE-FORM)
 ENERGY THROUGHPUT RATING: < 150 nJ
 PROTECTION CIRCUIT: DC BLOCKED

2. ENVIRONMENTAL CHARACTERISTICS

STORAGE/OPERATING TEMPERATURE: -40C TO +85C
 WEATHERIZATION: IP65
 VIBRATION: MIL-STD 202, METHOD 204, CONDITION B
 RoHS COMPLIANT

3. MATERIAL AND FINISH

INNER CONNECTOR FEMALE: PHOSPHOR BRONZE, SILVER PLATE
 INNER CONNECTOR MALE: BRASS, SILVER PLATE
 BODY: ALUMINUM, WHITE BRONZE PLATE
 CONNECTOR HOUSING: BRASS, WHITE BRONZE PLATE
 COUPLING NUT: BRASS, WHITE BRONZE PLATE
 INSULATOR: PTFE
 O-RING: SILICONE RUBBER

| | |
|-----------|---------------|
| MATERIAL: | |
| | |
| | USED ON ASSY. |

| | | |
|-----------|----------|----------|
| DRAFTSMAN | M. ELLIS | 03/24/14 |
| CHECKER | M. ELLIS | 03/24/14 |
| APPROVED | M. ELLIS | 03/24/14 |

UNLESS OTHERWISE SPECIFIED
 ALL DIMENSIONS ARE IN INCHES
 MACHINED SURFACES FINISH 32 RMS MAX.
 REMOVE ALL BURRS .005 MAX. BREAK
 MACHINE CORNERS .005 MAX. FILLET R.
 TOLERANCES ON DECIMALS
 .XX ± .01 .XXX ± .005
 ANGLES ± 1° FRACTIONS ± 1/32

DO NOT SCALE DRAWING

| | | |
|--|-------------------------|-----------|
| TIMES MICROWAVE SYSTEMS | | |
| TITLE: SURGE PROTECTOR N FEMALE TO N MALE 2000-6000 MHz | | |
| DWG. NO. 68999 | DRWG. NO. LP-WBX-NMP | REV. A |
| SCALE: 2:1 | SHEET 1 OF 1 | |