

Datasheet

Connectors for TC 100A, TC 500A, TA 100C and TA 500C

Accessories IF1 and IF3



Connectors IF1 and IF3 are made of hot-dip galvanized steel, execution as elongate (-F) or angulate (-W) with different cross-section dimensions (drill hole).

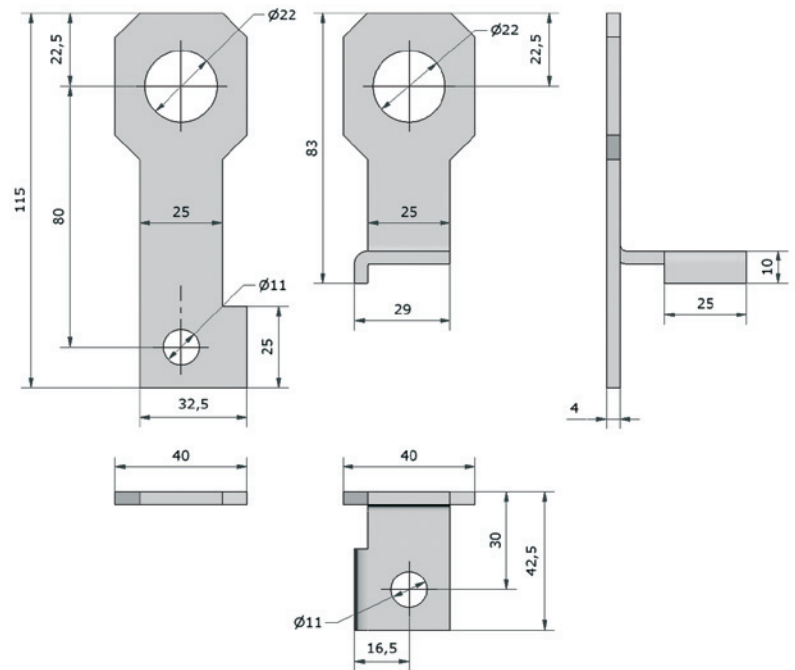

Dimension of IF1-22-W and IF3-22-F

Item no.	Product	Description
49 51 18	IF3-30-F	Connectors are made of hot-dip galvanized steel, elongate with 30 mm drill hole
49 51 19	IF1-30-W	Connectors are made of hot-dip galvanized steel, angulate with 30 mm drill hole
82 30 10	IF1-10-W	Connectors are made of hot-dip galvanized steel, angulate with 10 mm drill hole
82 30 11	IF1-22-W	Connectors are made of hot-dip galvanized steel, angulate with 22 mm drill hole
82 30 12	IF1-16-W	Connectors are made of hot-dip galvanized steel, angulate with 16 mm drill hole
82 30 15	IF3-18-F	Connectors are made of hot-dip galvanized steel, elongate with 18 mm drill hole
82 30 16	IF3-22-F	Connectors are made of hot-dip galvanized steel, elongate with 22 mm drill hole
82 30 17	IF3-16-F	Connectors are made of hot-dip galvanized steel, elongate with 16 mm drill hole
82 30 18	IF3-25-F	Connectors are made of hot-dip galvanized steel, elongate with 25 mm drill hole
82 30 19	IF1-23-W	Connectors are made of hot-dip galvanized steel, angulate with 23 mm drill hole
82 30 20	IF1-18-W	Connectors are made of hot-dip galvanized steel, angulate with 18 mm drill hole
82 30 21	IF1-42-W	Connectors are made of hot-dip galvanized steel, angulate with 42 mm drill hole
82 30 22	IF1-52-W	Connectors are made of hot-dip galvanized steel, angulate with 52 mm drill hole
82 30 23	IF1-15.8-W	Connectors are made of hot-dip galvanized steel, angulate with 15.8 mm drill hole
82 30 24	IF1-19.8-W	Connectors are made of hot-dip galvanized steel, angulate with 19.8 mm drill hole
82 30 25	IF1-22.2-W	Connectors are made of hot-dip galvanized steel, angulate with 22.2 mm drill hole
82 30 26	IF1-28.6-W	Connectors are made of hot-dip galvanized steel, angulate with 28.6 mm drill hole
82 30 27	IF1-32-W	Connectors are made of hot-dip galvanized steel, angulate with 32 mm drill hole
82 30 28	IF1-39-W	Connectors are made of hot-dip galvanized steel, angulate with 39 mm drill hole